

## Riva Park residential complex

Location **Famagusta, Yeni Boğaziçi**

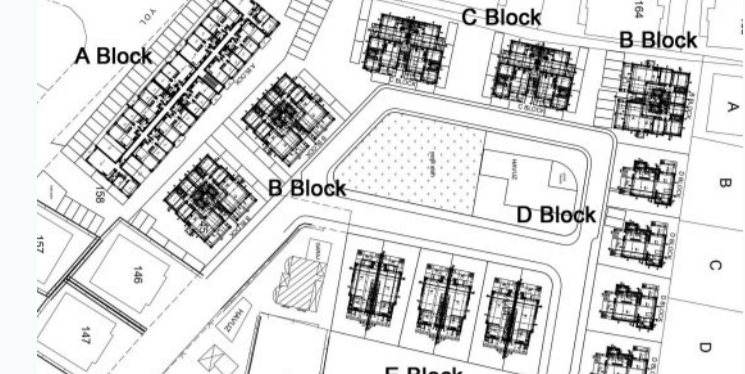

### About the project



Developer	<b>Erbatu</b>
Start of sale	<b>01.09.2022</b>
Key handover	<b>2025</b>
Houses/blocks	<b>13</b>
Building floor	<b>2</b> Min <b>2</b> Max
Units total	<b>8 - 1+1, 20 - 2+1</b>

Distance to the sea - 1500 m  
 Distance to key locations:  
 Airport 40 min. Supermarket 2 min. Pharmacy 4 min. School 4 min. Kindergarten 2 min. Hospital 4 min.

Riva Park is a unique residential complex offering the perfect combination of modern comfort, security and proximity to nature, located in the charming area of Yenibogaziçi. Here is a detailed description of this project: Perfect location: Riva Park is just a short walk from the beautiful beaches and just a 5-minute drive from Famagusta's vibrant urban infrastructure. This gives residents a unique opportunity to enjoy the sea and nature without losing access to urban amenities.

### Complex infrastructure

- Café
- Central generator
- Central satellite
- Kid's playground
- Open pool
- Rental office
- Security Camera System
- Shops
- VRF system

### Available units **16** / 59 total

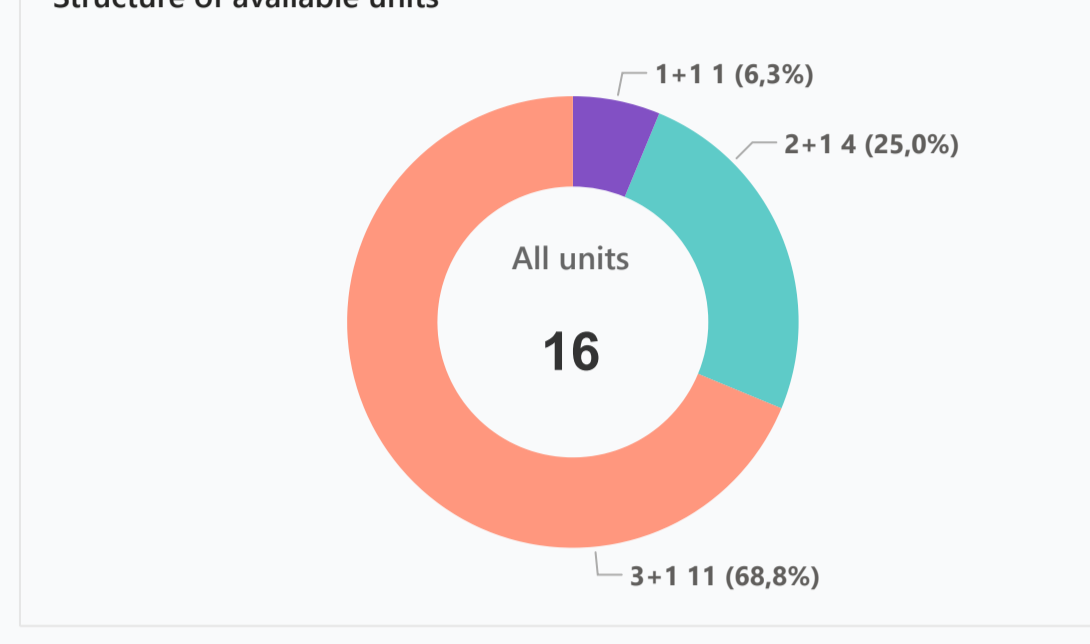
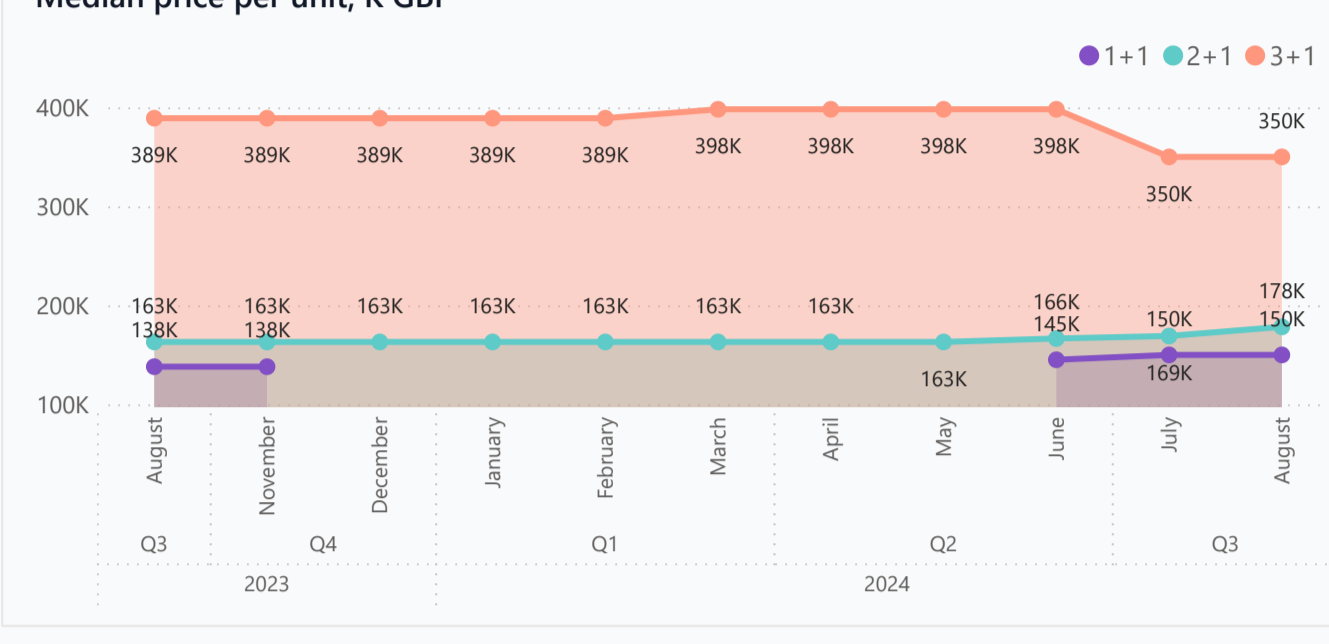

### Plans

ROOM TYPE	M <sup>2</sup>
Living room + Kitchen	26.8
Bedroom	13.2
Bathroom	5.3
Hall	2
Terrace	7.7



### 1+1

### 2+1 APARTMENT

ROOM TYPE	M <sup>2</sup>
Living room + Kitchen	30
Bedroom 1	13.3
Bedroom 2	13.3
Bathroom	4.2



### 2+1

### 3+1



### Payment plans **Deposit (non-refundable) 5000 GBP for a month**

Option	Down payment	Installments months	Discount	Offer
Option 1	<b>40 %</b>	40% till key, 20%...	-	-
Option 2	-	-	-	-
Option 3	-	-	-	-
Option 4	-	-	-	-

Special offer: **Fully furnished design package** and **Rental guarantee**

Trafo (Blank) GBP **Resale (Blank)** Maintenance fee - Rental services -

Bedrooms	Subtype	Block	Unit №	Floor	View	Bathroom	Internal area, sq. m	Balcony/Terrace, sq. m	Rooftop terrace, sq. m	Garden, sq. m	Gross covered area, sq. m	Current price, GBP	Price per sqm, GBP
1+1	Flat	C2	3	01							66	149 900	2 271
2+1	Flat	A	25	01							79	149 900	1 897
2+1	Flat	A	14.0	01							79	169 000	2 139
2+1	Flat	A	23	01							80	193 000	2 413
2+1	Flat	C1	4	01							88	187 500	2 131
3+1	Flat	B1	2	01							160	259 000	1 619
3+1	Flat	B1	3	02							160	259 000	1 619
3+1	Flat	B1	4	02							160	259 000	1 619
3+1	Villa	D	D2	0							240	449 900	1 875
3+1	Villa	D	D3	0							240	449 900	1 875
3+1	Villa	D	D4	0							240	449 900	1 875
3+1	Semi-Detached Villa	E	E1B	0							188	349 900	1 861
3+1	Semi-Detached Villa	E	E2A	0							188	349 900	1 861
3+1	Semi-Detached Villa	E	E2B	0							188	349 900	1 861
3+1	Semi-Detached Villa	E	E3A	0							188	349 900	1 861
3+1	Semi-Detached Villa	E	E3B	0							188	349 900	1 861

### Interior specification

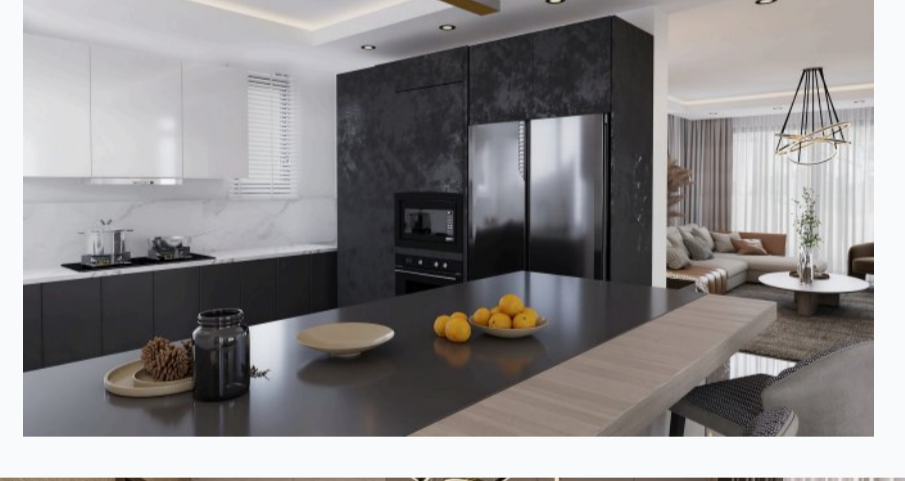

- Air Conditioner
- Ceramic flooring
- Double glazed windows
- Fitted wardrobes in each bedroom
- Granite kitchen worktop
- Laminated flooring in the bedrooms

### Exterior specification



- BBQ place on the roof
- Glass fence balcony
- Private Garden
- Terracing with inbuilt lighting & power sockets

### Location of complex

